



**WARNING:**

**CHOKING HAZARD – Small Parts  
Contains functional sharp edges  
Not for children under 3 years**

## Instructions:

**1**

Cut out pattern. Tape corners of pattern to your work surface. Peel protective covering from crafting plastic using your fingers to expose the adhesive surface. Tape corners of crafting plastic onto top of pattern.

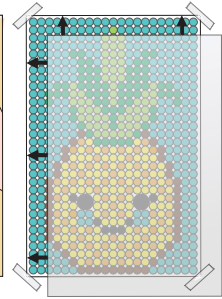
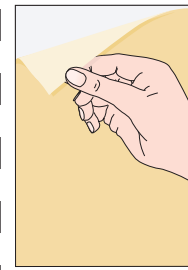

**2**

Break putty in half. Form one half of the putty over the tip of the applicator tool as illustrated.

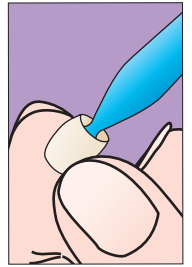
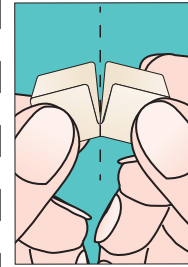

**3**

Hold applicator tool in your hand like a pencil. Press putty end onto top side of a rhinestone and pick it up.

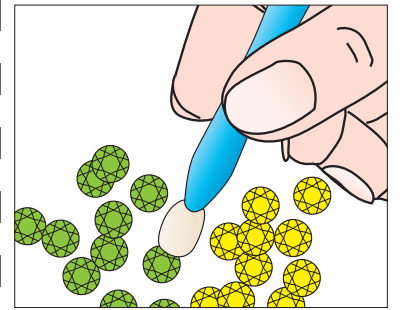

**4**

Place rhinestone onto adhesive surface of the crafting plastic following pattern for color and placement. Use opposite end of applicator tool to adjust position of rhinestone if necessary.

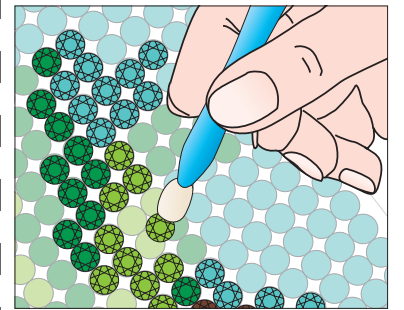

SS3101

