



## Apex Cage

IMPORTANT INFORMATION  
PLEASE READ AND KEEP  
DISCLAIMER

The following guidelines should be observed when using the Apex Cage.

- Always consult your physician before participating in any physical activity.
- Read all instruction carefully before using.
- Inspect the Apex Cage for damage before each use. DO NOT USE IF DAMAGED – REPLACE IMMEDIATELY.
- The Apex Cage is intended for use only as described in this document. Other uses are not recommended.
- Power Systems, Inc., assumes no liability for injuries, accidents, or damages that may occur with the use of the Apex Cage.

For more information regarding the Apex Cage  
Or other training products and programs, contact:

Power Systems, Inc  
[www.power-systems.com](http://www.power-systems.com)  
1-800-321-6975

Copyright © 2019 by Power Systems, Inc.

# Apex Cage

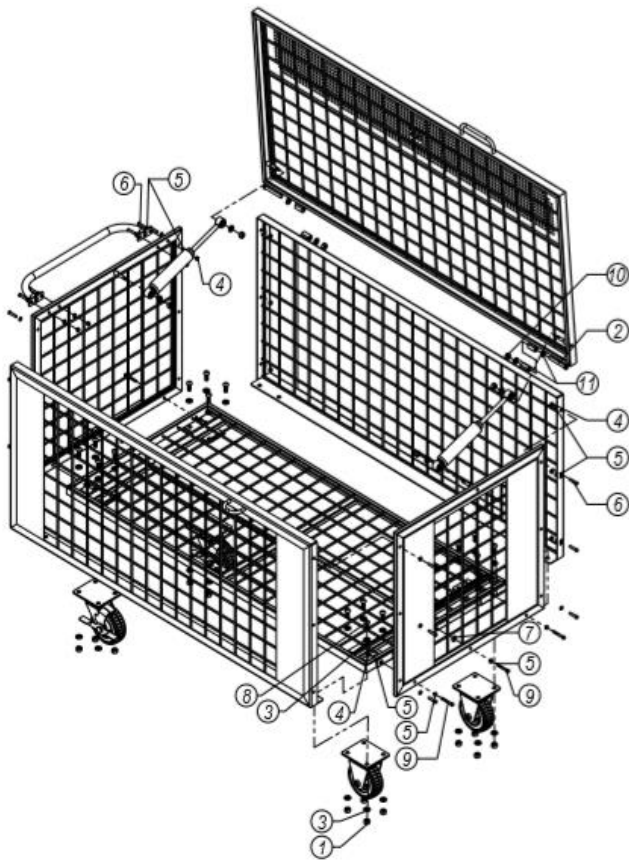

No.	DESCRIPTION	Q'TY
1	Nut_M10	16
2	Screws_M8X75	2
3	Plain Washer_Φ10	32
4	Nut_M6	22
5	Plain Washer_Φ6	44
6	Screws_M6X30	16
7	Large Washer_Φ6	2
8	Screws_M10X25	16
9	Screws_M6X45	6
10	Nut_M8	6
11	Plain Washer_Φ8	8

1. Attach the bottom panel to the side panels (These are the long panels)



2. Attach the front and back of the cage.(These are the short panels)



(The front panel will be the one with the loop that will be used for locking the unit.)



3. Attach the tires ensuring both locking tires are on the same end as your handle as shown.



4. Attach both pistons to the sides of the cage as shown in the diagram. Now attach the lid of the unit. Use caution in attaching the other end of the pistons to the lid as shown.



5. At this point ensure all bolts on the entire unit are correctly tightened before using your Apex Cage.

- Given the size and shape of the Apex Cage two person assembly is recommend.
- We recommend that you check the tire pressure ensuring they are evenly inflated before use.